

Soils Map

TRACT 2

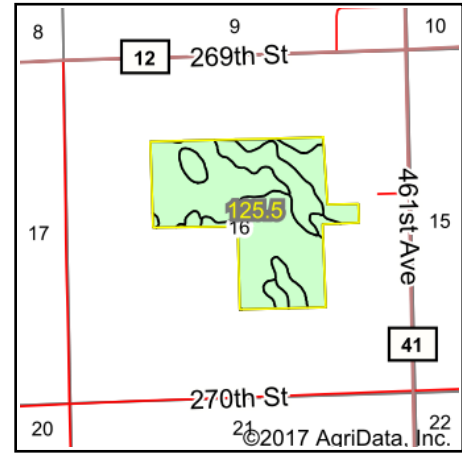

State: **South Dakota**
 County: **Turner**
 Location: **16-100N-52W**
 Township: **Home**
 Acres: **125.5**
 Date: **9/11/2017**

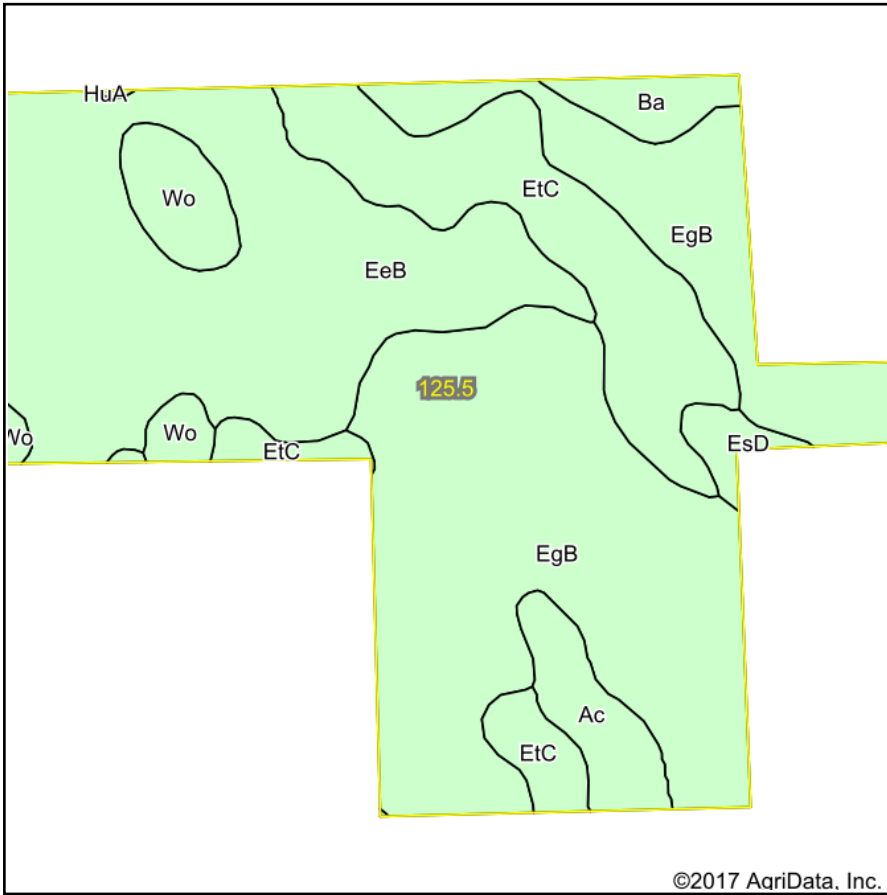

Maps Provided By:



© AgriData, Inc. 2017

www.AgriDataInc.com



Soils data provided by USDA and NRCS.

Area Symbol: SD125, Soil Area Version: 18

Code	Soil Description	Acres	Percent of field	Non-Irr Class *c	Irr Class *c	Productivity Index	Alfalfa hay	Barley	Corn	Soybeans	Spring wheat
EgB	Egan-Wentworth complex, 2 to 6 percent slopes	54.14	43.1%	Ile		84					
EeB	Egan-Ethan complex, 2 to 6 percent slopes	38.17	30.4%	Ile		77	4	47	77	29	32
EtC	Ethan-Egan complex, 5 to 9 percent slopes	19.58	15.6%	IVe		61	3.4	38	60	22	26
Wo	Worthing silty clay loam, 0 to 1 percent slopes	5.07	4.0%	Vw		30					
Ac	Alcester silty clay loam, cool, 0 to 2 percent slopes	4.48	3.6%	I	I	96					
Ba	Baltic silty clay loam	2.47	2.0%	Vw		37		5	29	10	4
EsD	Ethan-Betts loams, 6 to 15 percent slopes	1.53	1.2%	Vle		31	2.2	21	29	10	15
HuA	Huntimer silty clay loam, 0 to 2 percent slopes	0.06	0.0%	Iw		88	4.3	52	88	34	36
Weighted Average						75	1.8	20.6	33.7	12.6	14.1

*c: Using Capabilities Class Dominant Condition Aggregation Method

Soils data provided by USDA and NRCS.