

Soils Map

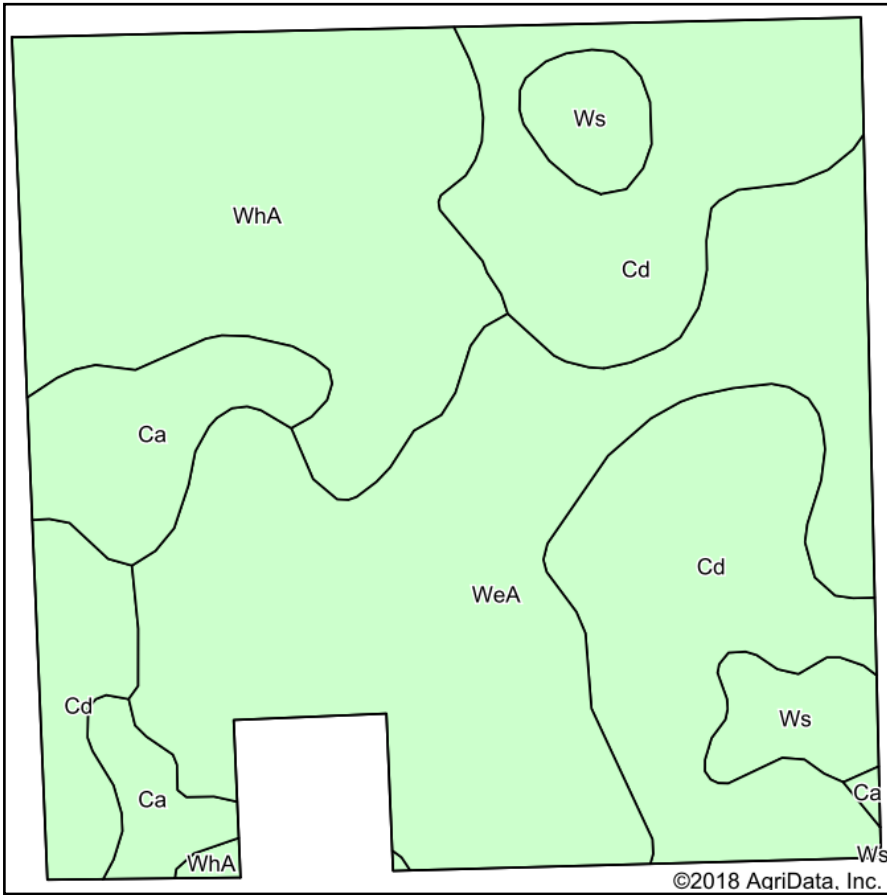

Soils data provided by USDA and NRCS.

©2018 AgriData, Inc.

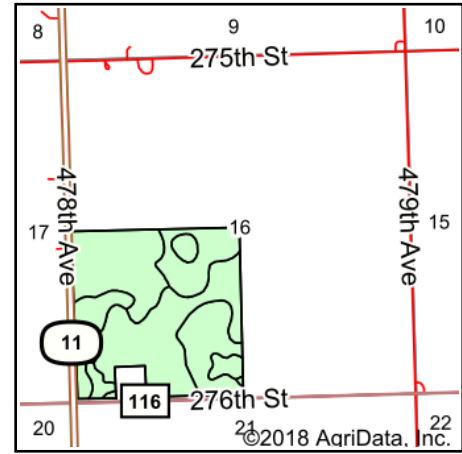

©2018 AgriData, Inc.

State: **South Dakota**
 County: **Lincoln**
 Location: **16-99N-49W**
 Township: **Dayton**
 Acres: **148.87**
 Date: **2/17/2018**



Maps Provided By:



© AgriData, Inc. 2018

www.AgriDataInc.com



Area Symbol: SD083, Soil Area Version: 19

Code	Soil Description	Acres	Percent of field	Non-Irr Class *c	Productivity Index	Alfalfa hay	Barley	Corn	Soybeans	Spring wheat
WeA	Wentworth silty clay loam, 0 to 2 percent slopes	48.71	32.7%	I	93					
Cd	Chancellor-Viborg silty clay loams	45.81	30.8%	IIw	87	3.7	47	94	35	33
WhA	Wentworth-Chancellor silty clay loams, 0 to 2 percent slopes	35.89	24.1%	Iw	88	4.1	51	98	37	36
Ca	Chancellor-Tetonka complex, 0 to 2 percent slopes	11.48	7.7%	IIw	75					
Ws	Worthing silty clay loam, 0 to 1 percent slopes	6.98	4.7%	Vw	30					
Weighted Average					85.6	2.1	26.8	52.6	19.7	18.8

*c: Using Capabilities Class Dominant Condition Aggregation Method

Soils data provided by USDA and NRCS.